

ARLINGTON, TEXAS MIDWAY AIRPORT

CAA DOCKET NO. 904-41-17 CONTRACT NO.

U.S. ENGINEER OFFICE
CONSTRUCTING AGENCY

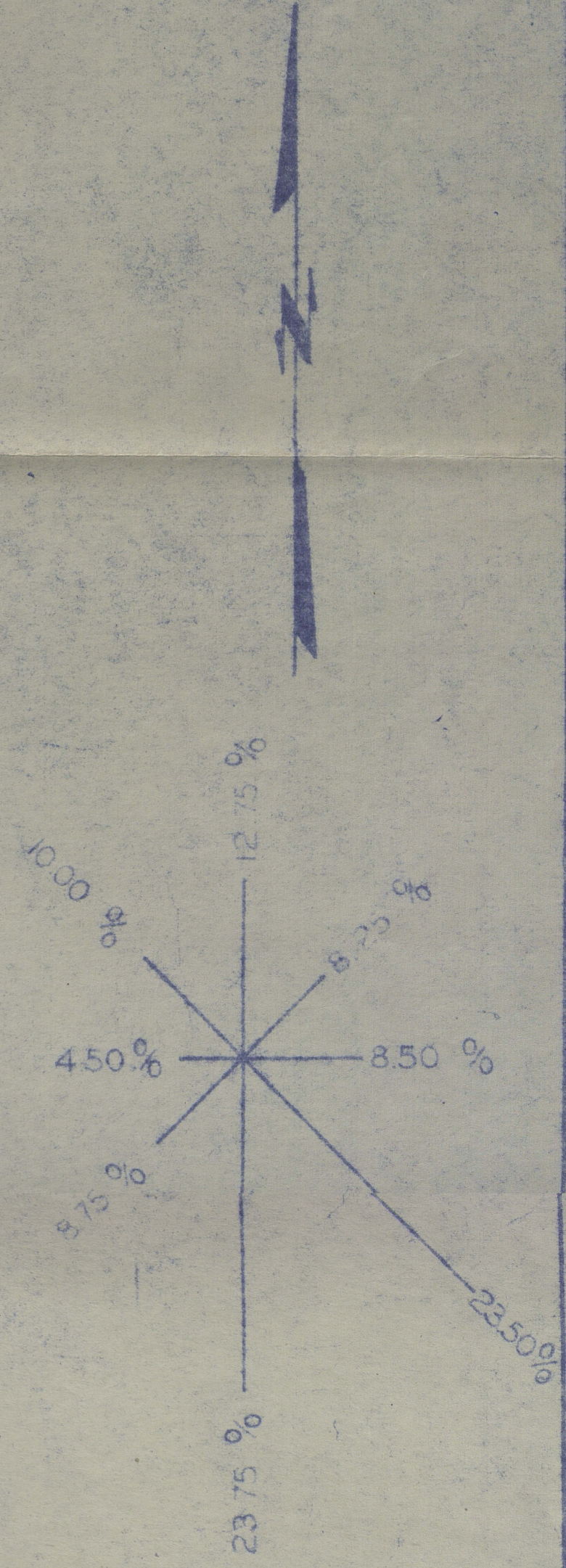
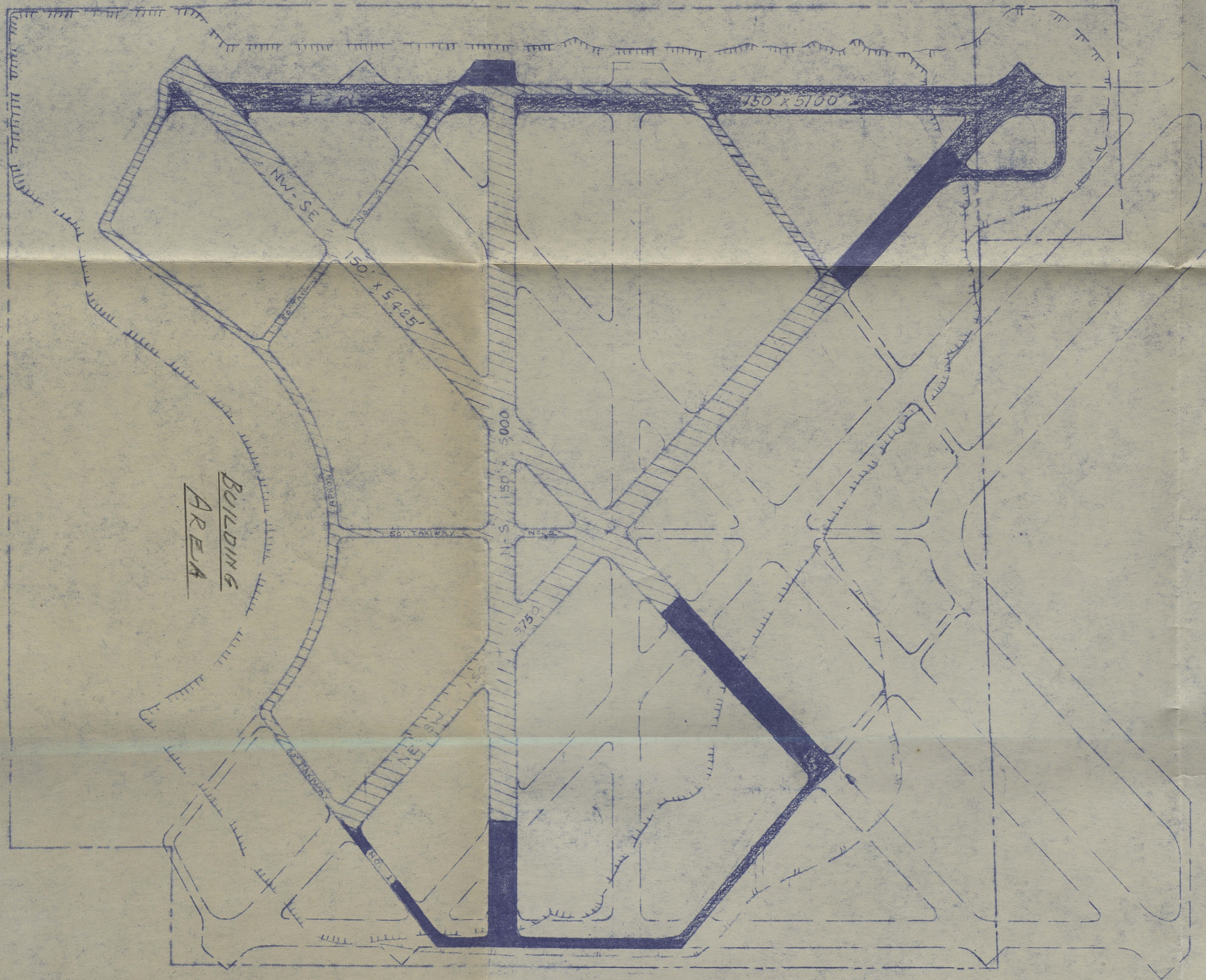

WINDROSE
(AVERAGE OF DALLAS & FT. WORTH)

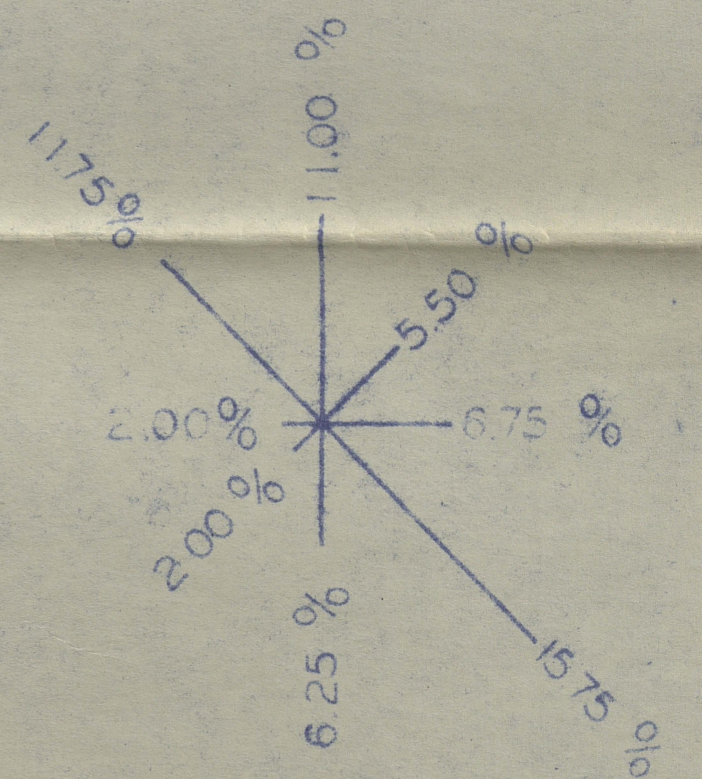

LOW VISIBILITY WINDROSE
(AVERAGE OF DALLAS & FT. WORTH)
CALMS = 39.00 %

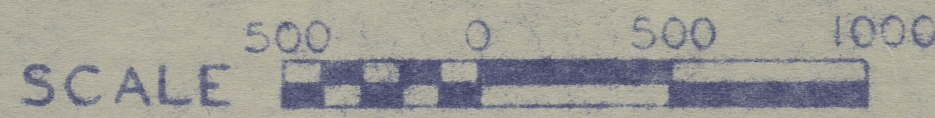

LEGEND

- CONSTRUCTION INCLUDED IN PROGRAM C
- PROPOSED ADDITIONAL CONSTRUCTION
- ULTIMATE DEVELOPMENT
- MINIMUM ADDED PROPERTY REQUIRED PRESENT PROPERTY LINE
- LIMITS OF GRADING FOR PROGRAM C
- APPROX. LIMITS OF ADDED GRADING FOR PROGRAM E
- DELETED CONSTRUCTION



LOCATION MAP
Scale 1" = 2 MI.

REVISIONS

6-9-43

U. S. DEPARTMENT OF COMMERCE		
CIVIL AERONAUTICS ADMINISTRATION		
AIRPORT DIVISION		
REGION 4	FT. WORTH, TEXAS	
CLASS 4	MASTER LAYOUT	ELEV. 580
ARLINGTON MUNICIPAL AIRPORT ARLINGTON, TEXAS, TARRANT CO.		
APPROVED:	REGIONAL MANAGER	
SUBMITTED:	SUPERVISOR OF AIRPORTS	
DRAWN BY: WOK	AIRPORT ENGINEER	
DATE: 4-30-43	ENGINEERING DRAFTSMAN	
SHEET 1	SCALE: 1" = 500'	DB. NO. 14 E