

LEGEND

IN USE VACANT

- FARM UNIT
- DWELLING
- ROW OF DWELLINGS
- SEASONAL DWELLING
- ROW OF SEASONAL DWELLINGS
- BUSINESS ESTABLISHMENT
- SEASONAL INDUSTRY
- CHURCH
- SCHOOL
- CAMP OR LODGE
- TOURIST CAMP
- POST OFFICE
- RACE COURSE OR FAIRGROUNDS
- ATHLETIC FIELD OR AMUSEMENT PARK
- SMALL PARK - STATE
- CEMETERY
- MONUMENT - SMALL
- LIMITS OF INSET

- COUNTY BOUNDARY
- CORPORATE LIMIT
- STATE HIGHWAY
- U. S. HIGHWAY
- PRIMITIVE ROAD
- PUBLIC ROAD

- S. H. D. WAREHOUSE
- PROMINENT ELEVATION
- RAILROAD - SINGLE OPERATING COMPANY
- RAILROAD UNDERPASS
- RAILROAD TUNNEL
- RAILROAD GRADE CROSSING
- RAILROAD STATION
- WIDE STREAM
- NARROW STREAM
- NARROW INTERMITTENT STREAM
- BRIDGE
- LONG BRIDGE
- CONCRETE FORD OR DIP
- FORD - ROAD ESTABLISHED
- CATTLE GUARD
- TOWN OR VILLAGE
- COUNTY SEAT
- INCORPORATED CITY

B.F.S.
J.O.F.
J.O.F.
J.M.J.
R.H.S.

30°10'

99°00'

98°55'

98°50'

G I L L E

30°05'

Y
T
N
U
O
C

30°00'

29°55'

R
R
E
R

29°50'

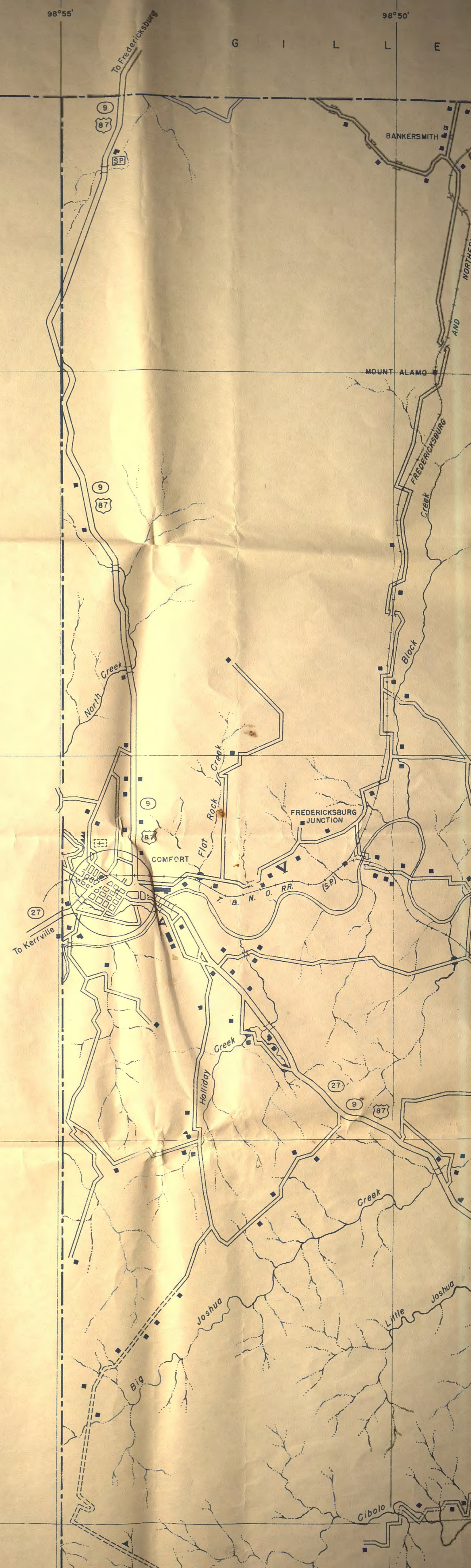



98°45'

98°40'

98°35'

98°45'

98°40'

98°35'

I E C O U N T Y

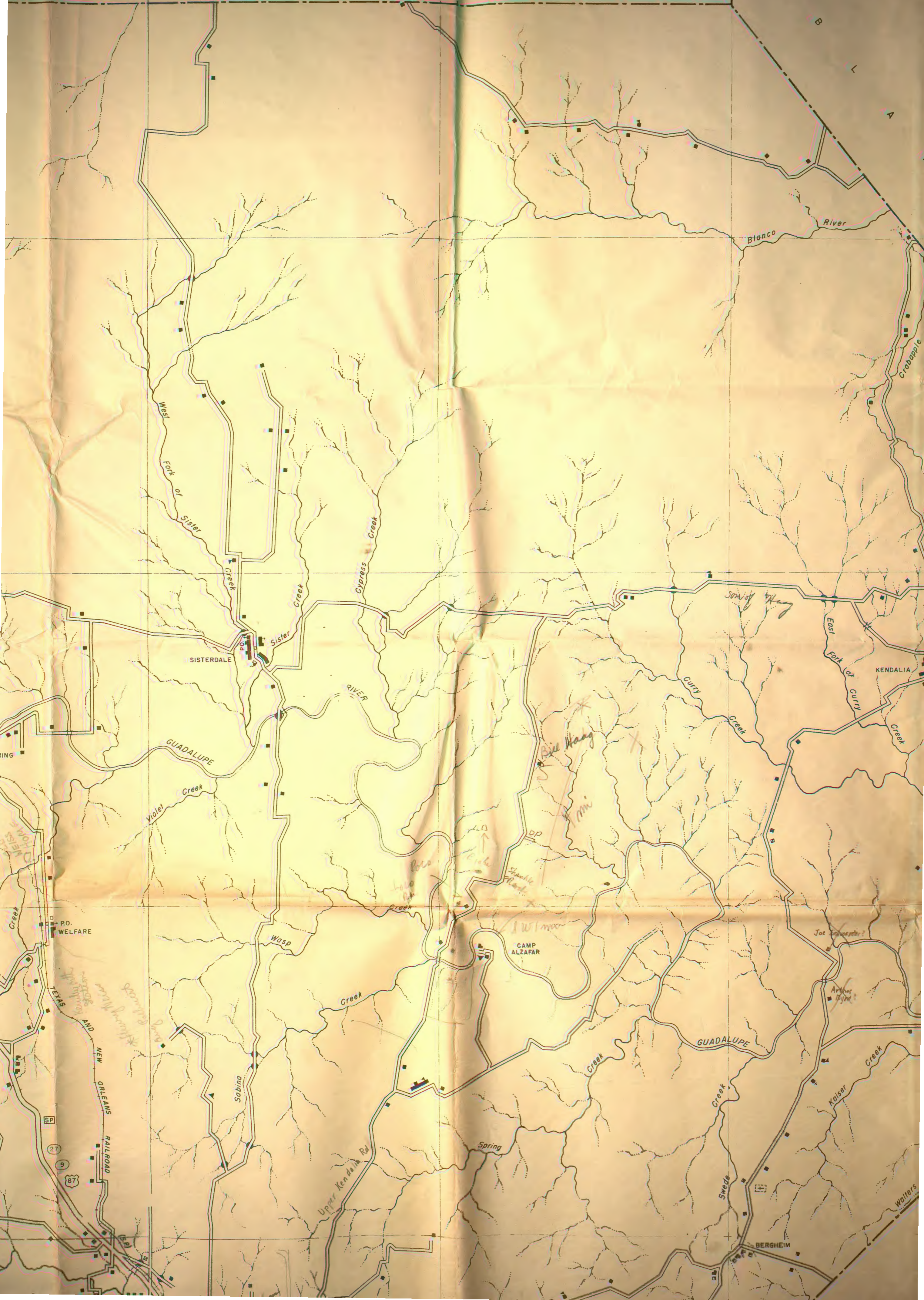

West Fork of Sister Creek

SISTERDALE

GUADALUPE

Violet Creek

RIVER

Wasp

Creek

Sabina

Upper Kendall Rd

Spring

CAMP ALZARFAR

GUADALUPE

Creek

Swede

BERGHEIM

Kaiser

Creek

Walters

Blanco

River

Crobbopple

KENDALIA

East Fork of Curry

Curry

South Fork

Bill King

1 mi

Joe

Joe

Arthur

Frank

NEW ORLEANS RAILROAD

SP

27

9

87

60

98°30' 30°10' 98°25'

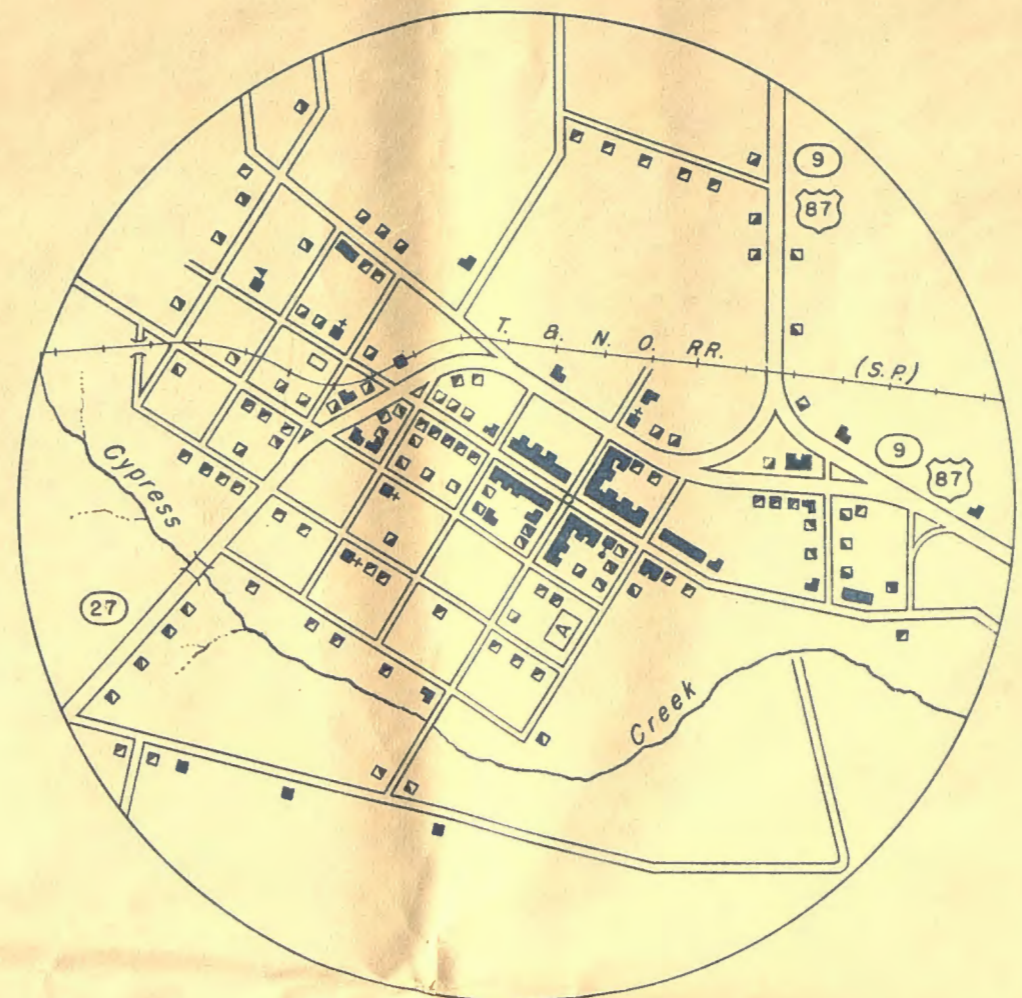

COMFORT
Scale: 4" = 1 Mile

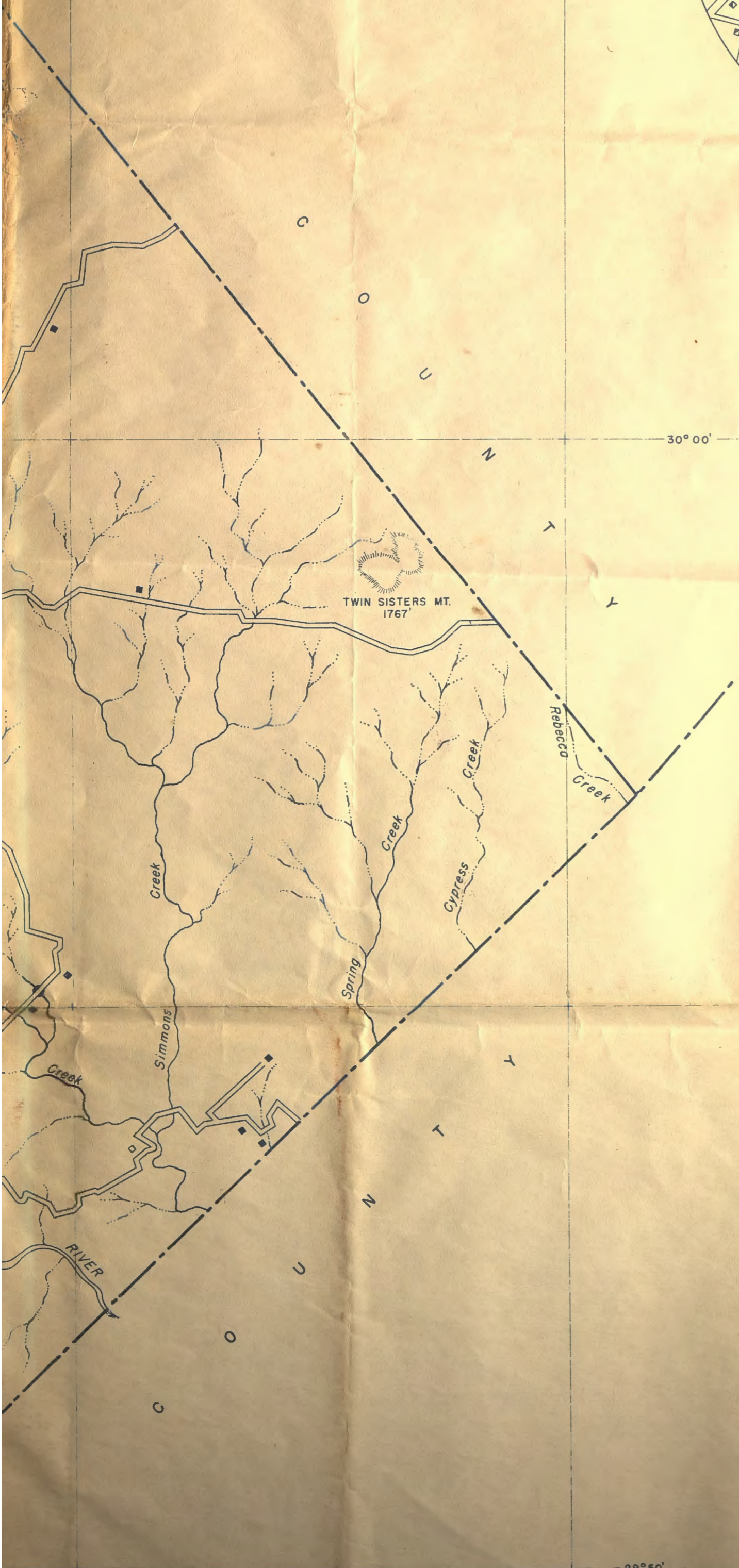

30°05'
30°00'
29°55'
29°50'

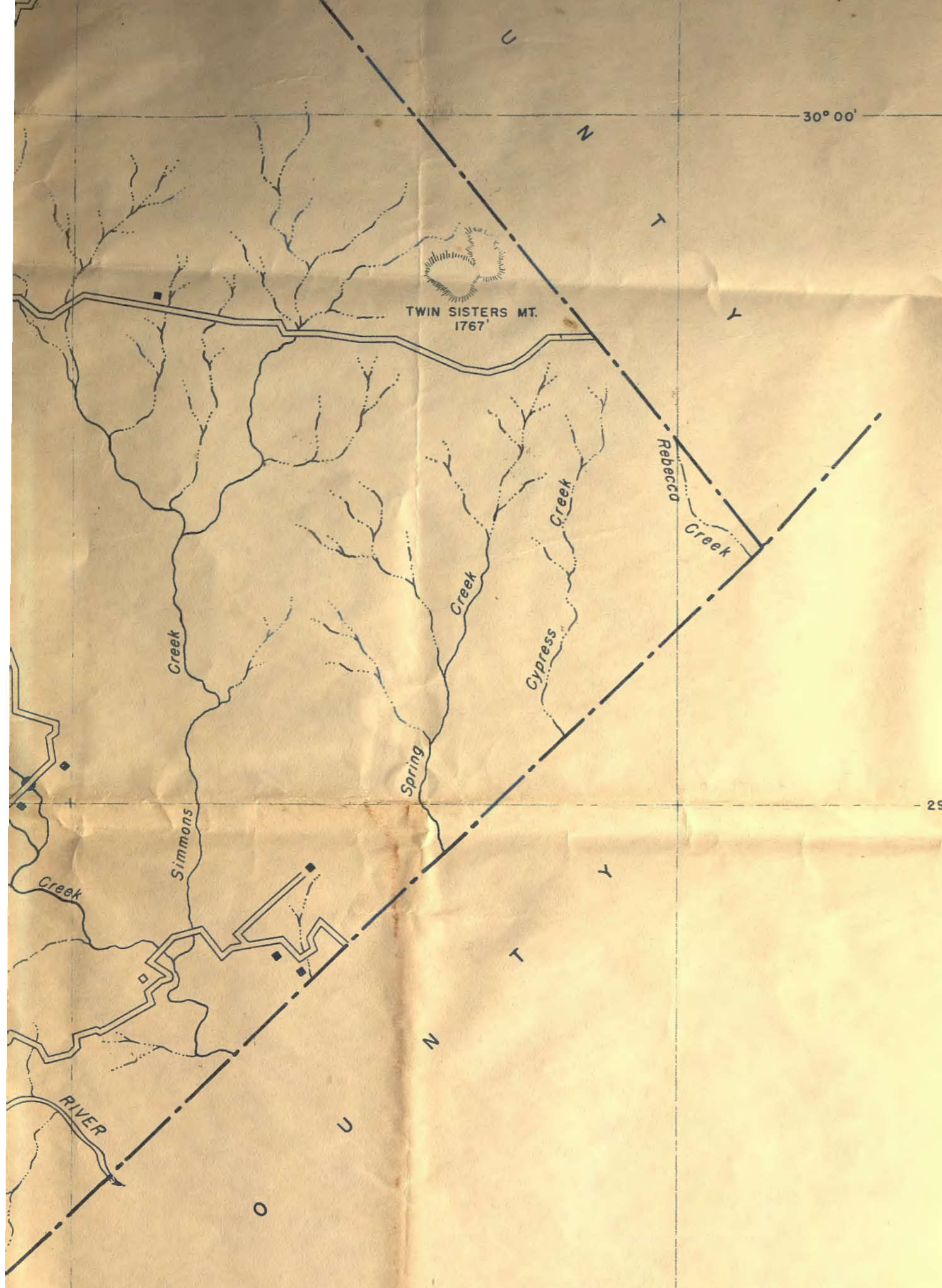

KENDALL COUNTY TEXAS

PREPARED BY THE
 TEXAS STATE HIGHWAY DEPARTMENT
 IN COOPERATION WITH THE
 U. S. DEPARTMENT OF AGRICULTURE
 BUREAU OF PUBLIC ROADS
 DATA OBTAINED FROM
 STATE-WIDE HIGHWAY PLANNING SURVEY

SCALE - 1 INCH = 1 MILE

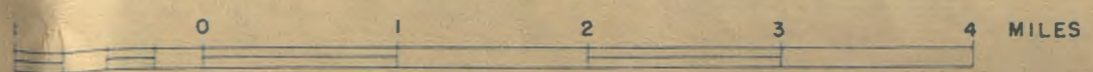

1936

POLYCONIC PROJECTION NORTH AMERICAN DATUM

Control U. S. Coast and Geodetic Survey and U. S. Geological Survey supplemented
 by U. S. Engineer's Surveys, Railroad Alignments, State Highway Alignments
 and State-Wide Highway Planning Survey's Road Inventory