

hg = hand glass

① Pure white specks - 10x hg snow white 4x16 mm  
Irreg.

② Irreg yellowish agglomerat glassy grains 10x hg  
1 group roughly ellip shattered sub-crystalline slightly yellowish  
grains  tend to look brassy-opaque 4x16 mm. One  
glassy piece with side broken under strain? // show  
strain. Prod olivine - or feldspar - troctite? Bubble seen in  
& I showed strain / tiny idor area - prismatic.

③ Gray chondri mostly circular break with mass  
10x hg. 1 ring & metallic grains? 4x16 mm. These & give  
silvery look esp under art light, simulat deliquescent particles.  
Partly metallic?

④ Gray chondri, polyhedral ③ often not break  
with matrix 10x hg. Shattered grouping of gray & black  
fragments result in ball-shaped unit 4x16 mm. Rather  
rough, some matted appearance & interiors (?) - prob rough rather  
than strictly polyhedral.

⑤ Small reddish-amber sub-crystalline grain.  
4x16 mm

⑥ Groundmass richer in metallic grain sprinkles than T speed, these often represent of I at 1st took  
#3 above? 4x16 mm

⑦ Crust thin - mostly raised ridges show flow tendency, with many lighter grains & whitish material show thru, esp in antiven area lot melted ridges.  
Crust very pockety + craterlet-form. 4x16 mm. On another piece crust thicker & less shows thru, adhesion grains possibly impurities from <sup>earth</sup> ground; ridges swollen & bead-like - hollow or part?

⑧ Red sands. Object struck readily distinguishable.  
Partly fused to crust? 4x16 mm

2nd map

# MAP OF LOGAN COUNTY OKLAHOMA

**LEGEND**

- State Roads
- County Roads
- Railroads
- Interurbans
- Streams

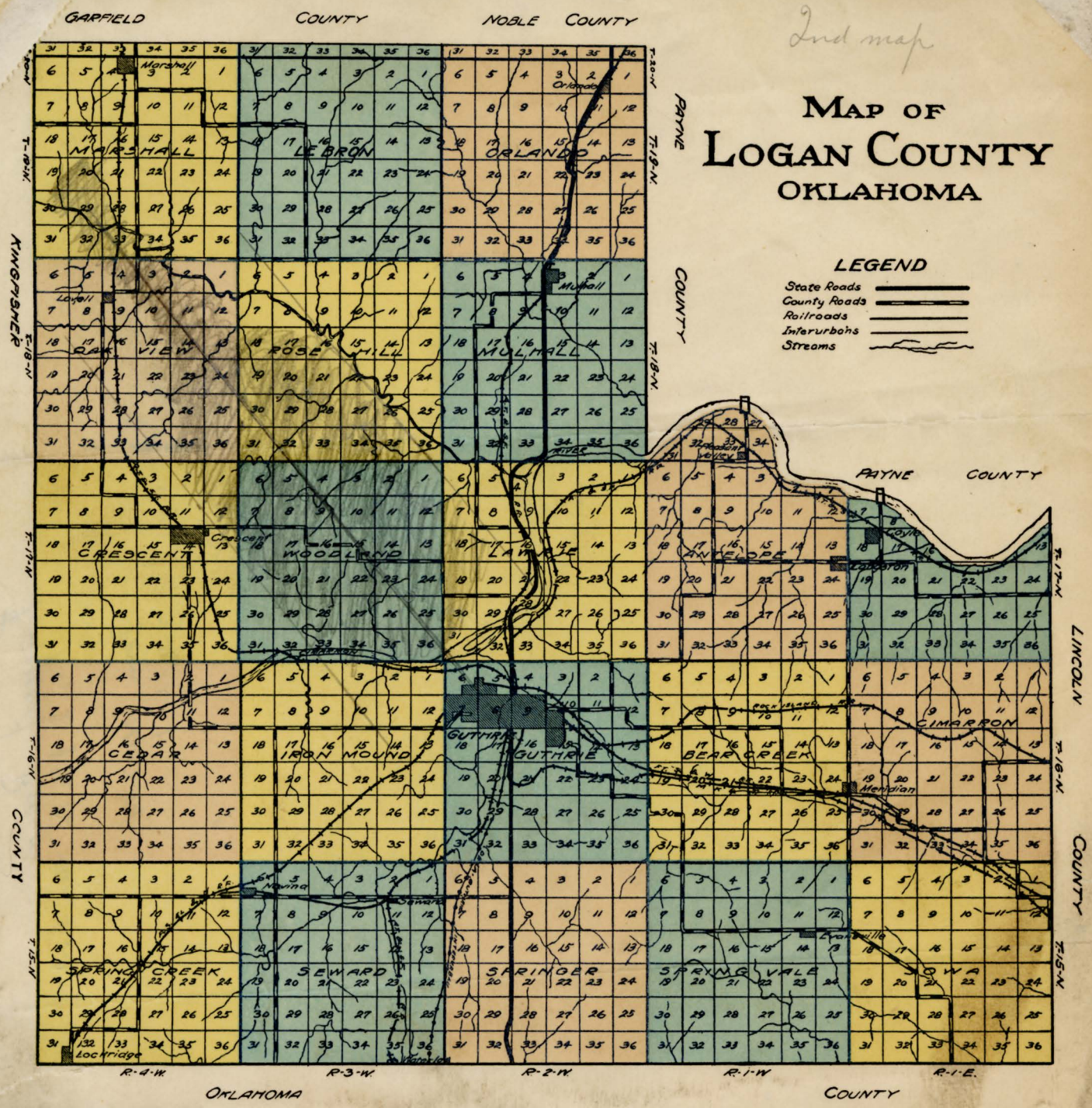

**JELSMA ABSTRACT COMPANY**  
 Bonded by Surety Company  
 COMPLETE SET OF INDEXES IN OFFICE  
 Phone 12 and L. D. 12  
 GUTHRIE, OKLAHOMA

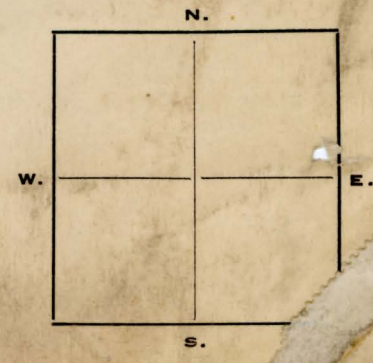

GARFIELD

COUNTY

NOBLE COUNTY

# MAP OF LOGAN COUNTY OKLAHOMA

## LEGEND

- State Roads
- County Roads
- Railroads
- Inferurbans
- Streams

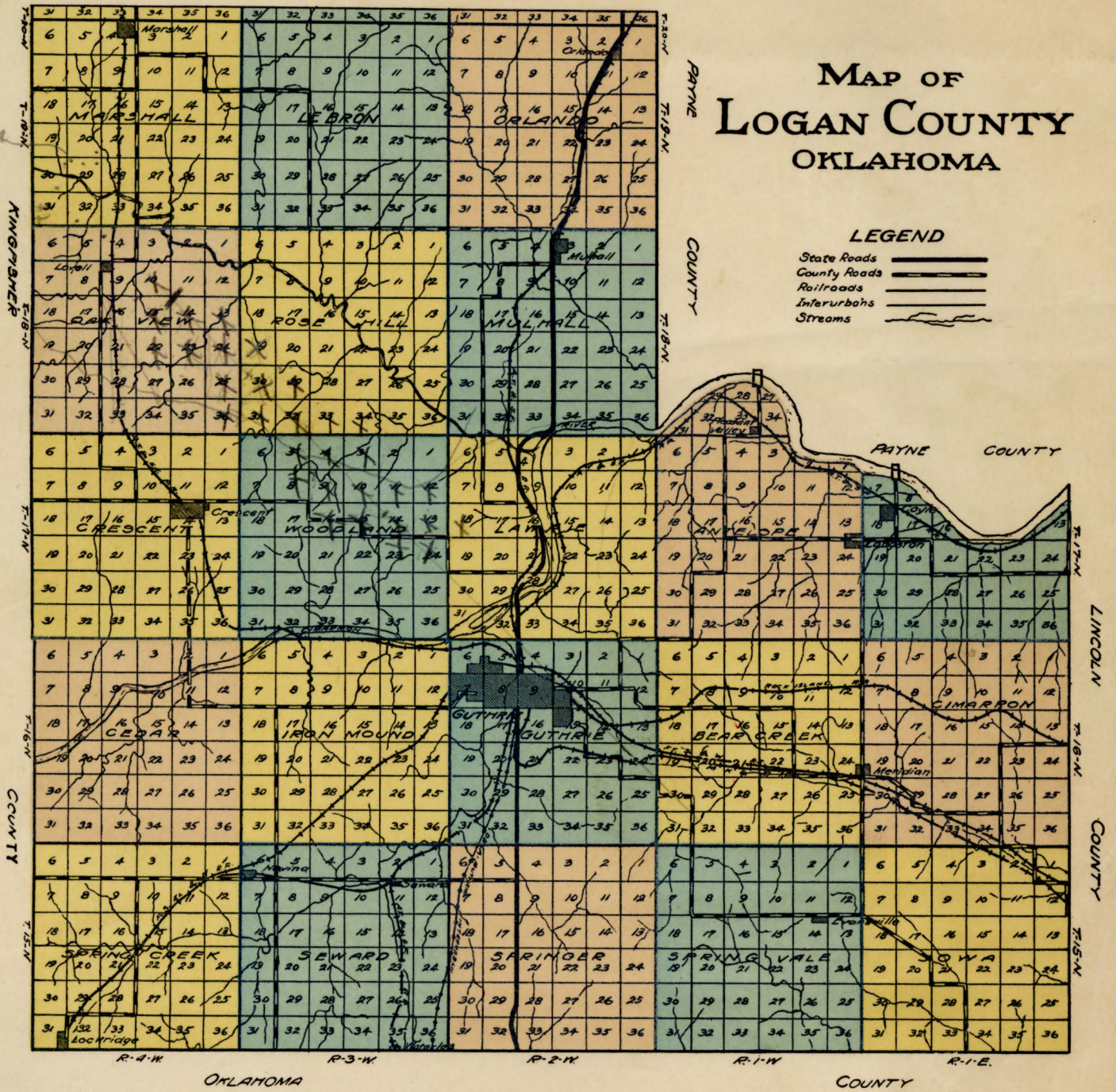

# JELSMA ABSTRACT COMPANY

## Bonded by Surety Company

COMPLETE SET OF INDEXES IN OFFICE

Phone 12 and L. D. 12

### GUTHRIE, OKLAHOMA

